

PLANTS LISTED IN ORDER OF MATURE SIZE

1. [American Beautyberry](#) (*Callicarpa americana*):
 - **Mature Size:** 3-6' H x 3-6' W
 - **Growth Rate:** Moderate
 - **Canopy Shape:** Loose, open, shrub
 - **Leaf:** Deciduous. Yellow-green Fall color
 - **Flower:** Monoecious, small pink clusters
 - **Fruit:** Showy, iridescent-purple drupes
 - **Drought Tolerance:** Moderate
 - **Wildlife Value:** High (birds, pollinators)
 - **Pest/Disease:** Low
 - **Culture:** Full sun to light shade, in moist, organic-rich soils. Avoid high soil pH.
 - **Quantity Available:** 30
2. [American Fringetree](#) (*Chionanthus virginicus*):
 - **Mature Size:** 12-20' H x 10-15' W
 - **Growth Rate:** Slow
 - **Canopy Shape:** Oval, round, symmetrical
 - **Leaf:** Deciduous. Showy yellow fall color
 - **Flower:** Dioecious/perfect, showy/fragrant
 - **Fruit:** Showy drupe, female plants only
 - **Drought Tolerance:** Moderate
 - **Wildlife Value:** Moderate
 - **Pest/Disease:** Low
 - **Culture:** Full sun to part shade, in well-drained clay, loam or sandy soils
 - **Quantity Available:** 90
3. [Dahoon Holly](#) (*Ilex cassine*):
 - **Mature Size:** 20-30' H x 8-12' W
 - **Growth Rate:** Moderate
 - **Canopy Shape:** Pyramidal, oval irregular
 - **Leaf:** Evergreen, no fall color change
 - **Flower:** Dioecious, not showy
 - **Fruit:** Showy, round drupe
 - **Drought Tolerance:** Moderate
 - **Wildlife Value:** Moderate
 - **Pest/Disease:** Low
 - **Culture:** Full sun to part shade, in wet to well-drained clay, loam or sandy soils
 - **Quantity Available:** 30
4. [Overcup Oak](#) (*Quercus lyrata*):
 - **Size/Rate:** 40-60' H x 40-60' W
 - **Growth Rate:** Slow
 - **Canopy Shape:** Broad, rounded
 - **Leaf:** Deciduous, yellow-brown fall color
 - **Flower:** Monoecious, catkins, showy
 - **Fruit:** Large, distinct acorns
 - **Drought Tolerance:** Moderate
 - **Wildlife Value:** High
 - **Pest/Disease:** Low
 - **Culture:** Full sun to part shade, in acidic moist to wet loamy soil
 - **Quantity Available:** 15
5. [Red Maple](#) (*Acer rubrum*):
 - **Mature Size:** 60-75' H x 20-35' W
 - **Growth Rate:** Fast
 - **Canopy Shape:** Oval, round, upright
 - **Leaf:** Deciduous, showy mixed fall color
 - **Flower:** Dio and monoecious, not showy
 - **Fruit:** Showy, two-winged samara
 - **Drought Tolerance:** Moderate
 - **Wildlife Value:** Moderate
 - **Pest/Disease:** Moderate
 - **Culture:** Full sun to part shade, in well-drained clay, loam or sandy soils
 - **Quantity Available:** 60
6. [Bald Cypress](#) (*Taxodium distichum*):
 - **Size/Rate:** 60-80' H x 25-30' W
 - **Growth Rate:** Fast
 - **Canopy Shape:** Pyramidal, upright
 - **Leaf:** Deciduous, showy, copper fall color
 - **Flower:** Monoecious, not showy
 - **Fruit:** Showy, small, round-ovulate cone
 - **Drought Tolerance:** High
 - **Wildlife Value:** Moderate
 - **Pest/Disease:** Low
 - **Culture:** Full sun to part shade, in wet to well-drained clay, loam or sandy soils
 - **Quantity Available:** 30



City of Hoover Arbor Day 2022

Event hosted by the Hoover Beautification Board
Trees sponsored in part by Alabama Power Company



PLANTS LISTED IN ORDER OF MATURE SIZE

7. [Longleaf Pine](#) (*Pinus palustris*):
 - **Mature Size:** 60-80' H x 30-40' W
 - **Growth Rate:** Slow
 - **Canopy Shape:** Upright, oval, open
 - **Leaf:** Evergreen needles in clusters
 - **Flower:** Monoecious, catkins, showy
 - **Fruit:** Large, showy cones
 - **Drought Tolerance:** High
 - **Wildlife Value:** High
 - **Pest/Disease:** Low
 - **Culture:** Full sun to part shade, in alkaline, rich, loamy or clay soils
 - **Quantity Available:** 30

8. [American Sycamore](#) (*Platanus occidentalis*):
 - **Mature Size:** 75-100' H x 75-100' W
 - **Growth Rate:** Grows very large, very fast!
 - **Canopy Shape:** Upright, spreading, rounded
 - **Leaf:** Deciduous, large, yellow-brown in fall
 - **Flower:** Monoecious, not showy
 - **Fruit:** Spherical, fuzzy balls. Showy
 - **Drought Tolerance:** Low
 - **Wildlife Value:** Moderate
 - **Pest/Disease:** Low
 - **Culture:** Full sun to light shade in rich, humusy and consistently-moist soils. Best suited for large, wetter, natural areas
 - **Quantity Available:** 15

Tree giveaways begin at 9:00 a.m. on Sat., 3/5 at Hoover Randle House, Aldridge Gardens & Greystone Elem. Trees are FREE to Hoover residents while supplies last! Please call (205) 739-7141 or email colin.conner@hooveralabama.gov with questions.

Containerized Tree Planting Instructions

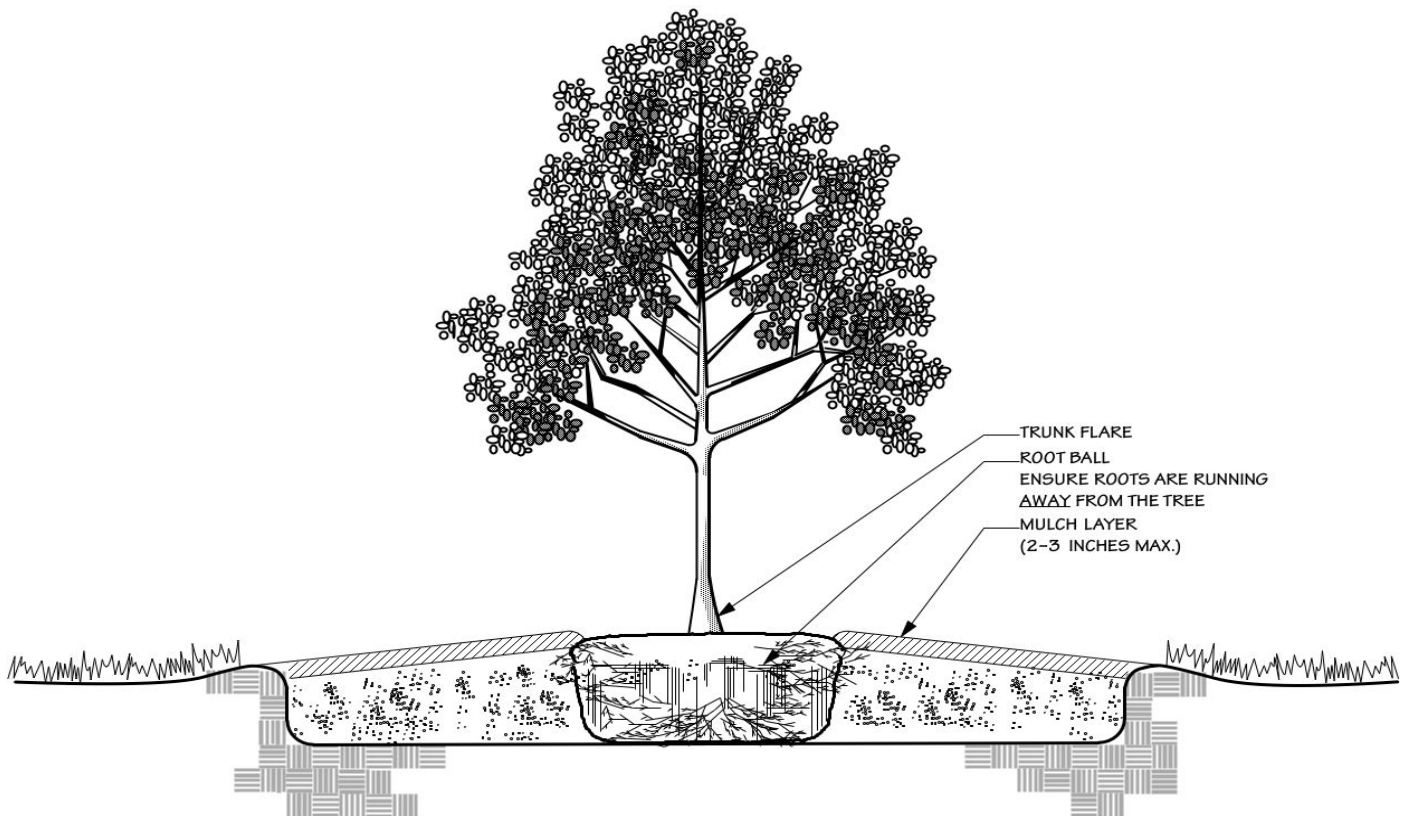

Site conditions and planting procedures are vital to a tree's establishment and long-term health. After selecting an appropriate planting site, refer to these basic guidelines as you plant your new tree:

1. As much as possible, handle your new tree by its root ball instead of its trunk or lateral branches.
2. **"Find the Flare"** or trunk flare, where the top-most lateral root grows away from the trunk, into the soil.
3. **Dig a broad / shallow planting hole, 2-3x the diameter of the root ball and just deep enough to set the trunk flare slightly higher than the level of the surrounding soil.** Pile and pulverize all the soil removed from the planting hole, saving it for Step #6. Note: Amending backfill with fertilizer is not recommended. If the soil you removed from the planting hole is very poor, a light (+/- 20%) amendment of top soil or composted leaves can be beneficial. Turn the amendment thoroughly into the pulverized pile of backfill.
4. **Remove root ball container** by gently pulling or cutting it away.
5. **Address circling and/or girdling roots:**
 - Over time, roots growing inside plastic nursery containers can develop a circling growth habit. Circling roots should be redirected by hand to run laterally from the trunk, or pruned as far away from the trunk as possible. When left uncorrected, circling roots can become girdling roots which are a common cause of structural failure and mortality in planted, container-grown trees.
6. **Stand your tree in its planting hole and backfill.** Center your tree in the planting hole. Right the tree vertically on a firm foundation, then gently backfill around the root ball using your pulverized backfill. As you backfill, add water to settle out air pockets.
7. **Mulch the entire surface area of the planting hole.** Pine bark works well on flat areas; pine straw on slopes. Mulch depth should not exceed 3" and mulch should not contact or bury the tree's trunk.
8. **Maintain and enjoy your new tree through establishment and beyond!** Minimize unnecessary disturbance, provide supplemental water to maintain consistent soil moisture, maintain a shallow but broad mulched area, trim as necessary for good structure and monitor for pests.